

ST. TAMMANY PARISH COUNCIL

ORDINANCE

ORDINANCE CALENDAR NO: 4850

ORDINANCE COUNCIL SERIES NO: _____

COUNCIL SPONSOR: GOULD/BRISTER

PROVIDED BY: PLANNING

INTRODUCED BY: MR. BINDER

SECONDED BY: MR. BELLISARIO

ON THE 2 DAY OF AUGUST , 2012

ORDINANCE TO PERMIT THE CROSSING OF THE ST. TAMMANY TRACE FOR THE PURPOSE OF PROVIDING A SUBSURFACE GAS PIPELINE. (WARD 4, DISTRICT 7)

WHEREAS, Parkway Pipeline, L.L.C., has petitioned St. Tammany Parish to permit them to cross the Tammany Trace by boring under the Tammany Trace for the purpose of installing a gas pipeline. The approximate location of work is located near Bayou Castine where it crosses the Trace on the south side of U.S. Highway 190, Mandeville, Louisiana; and

WHEREAS, the petitioner claims that the crossing of the Trace is needed since there are no other alternatives to provide said services; and

WHEREAS, upon review and consideration by the St. Tammany Parish Planning Commission at a regularly scheduled public hearing, and after hearing testimony from all concerns, hereby recommends that the Parish Council approve the proposed request subject to the stipulations as referenced to below.

THE PARISH OF ST. TAMMANY HEREBY ORDAINS that the Parkway Pipeline, L.L.C., may cross under and over the Tammany Trace subject to the following:

- a.) The Trace shall not be closed or obstructed for more than one hour at any time.
- b.) Parkway Pipeline, L.L.C. provide the parish with a hold harmless agreement in favor of the Parish.
- c.) All construction on the Trace shall occur only Monday through Friday (no weekends).
- d.) The Trace must be kept clean and free of debris at all times.
- e.) Parkway Pipeline, L.L.C. shall procure written approval from the Tammany Trace Supervisor.

REPEAL: All ordinances or parts of Ordinances in conflict herewith are hereby repealed.

SEVERABILITY: If any provision of this Ordinance shall be held to be invalid, such invalidity shall not affect other provisions herein which can be given effect without the invalid provision and to this end the provisions of this Ordinance are hereby declared to be severable.

EFFECTIVE DATE: This Ordinance shall become effective fifteen (15) days after adoption.

MOVED FOR ADOPTION BY: _____ SECONDED BY: _____

WHEREUPON THIS ORDINANCE WAS SUBMITTED TO A VOTE AND RESULTED IN THE FOLLOWING:

YEAS: _____

NAYS: _____

ABSTAIN: _____

ABSENT: _____

THIS ORDINANCE WAS DECLARED DULY ADOPTED AT A REGULAR MEETING OF THE PARISH COUNCIL ON THE 6 DAY OF SEPTEMBER , 2012 ; AND BECOMES ORDINANCE COUNCIL SERIES NO _____.

MARTIN W. GOULD, JR., COUNCIL CHAIRMAN

ATTEST:

THERESA L. FORD, COUNCIL CLERK

PATRICIA P. BRISTER, PARISH PRESIDENT

Published Introduction: JULY 26 , 2012

Published Adoption: _____, 2012

Delivered to Parish President: _____, 2012 at _____

Returned to Council Clerk: _____, 2012 at _____

ADMINISTRATIVE COMMENTS
(TRC12-07-001 - Crossing Under the Tammany Trace)

The staff has no objections to Parkway Pipeline, L.L.C., crossing under the Tammany Trace for the purpose of boring under the Trace to install a gas pipeline subject to the following conditions:

- a.) The Trace shall not be closed or obstructed for more than one hour at any time.
- b.) Parkway Pipeline, L.L.C. provide the parish with a hold harmless agreement in favor of the Parish.
- c.) All construction on the Trace shall occur only Monday through Friday (no weekends).
- d.) The Trace must be kept clean and free of debris at all times.
- e.) Parkway Pipeline, L.L.C. shall procure written approval from the Tammany Trace Supervisor.

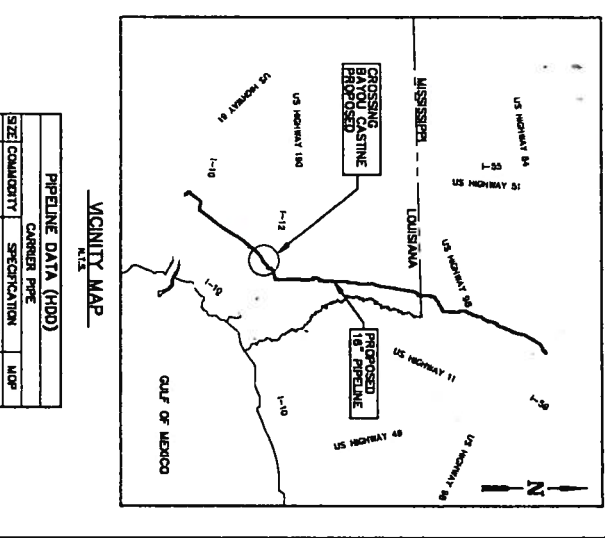
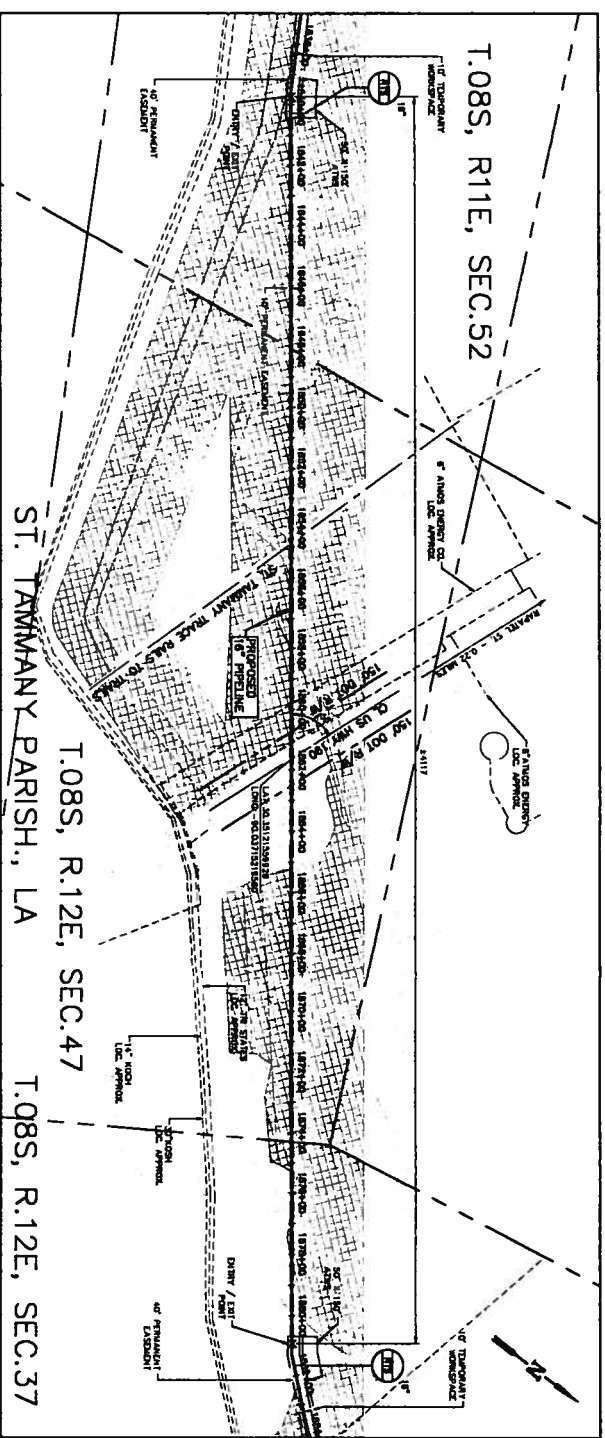

PLAN
SCALE 1"=400'

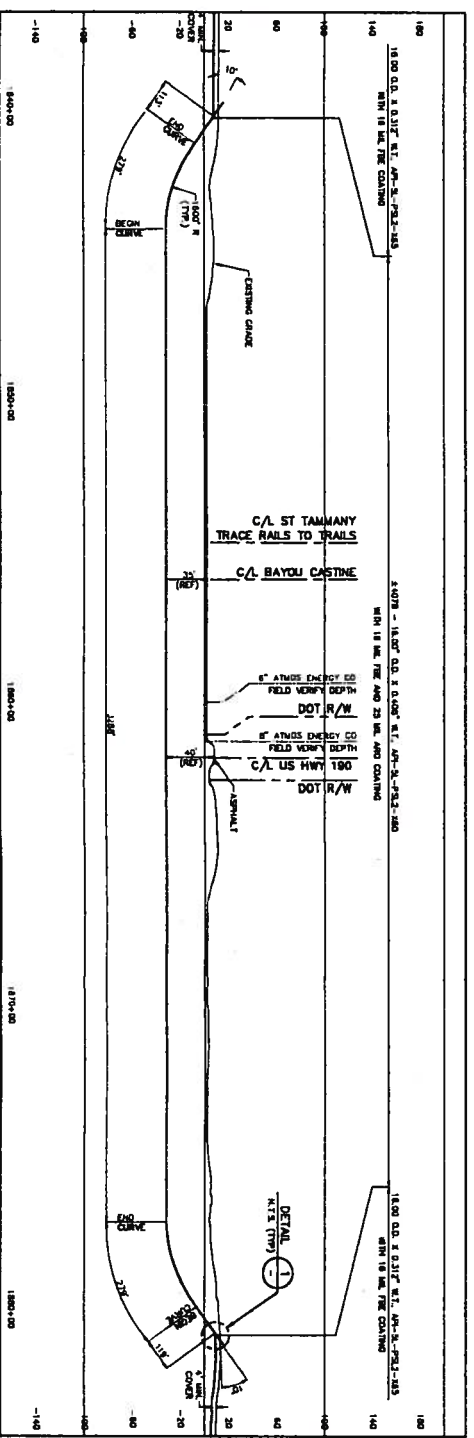

PROFILE
HORIZ. 1"=200'
VERT. 1"=40'

PIPELINE DATA (HDD)
CARRIER PIPE

SIZE	CAPACITY	SPECIFICATION	W.P.
18"	100 GPM	API 5L, X42, 100ksi	1400 PSIG
18"	100 GPM	15 MILS. OF WALL THICKNESS	1500 PSIG

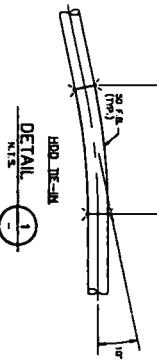

- NOTES:
1. THE HORIZONTAL, SECTIONAL, AND PROFILE SHOWN ON THE DRAWING IS FOR CONCEPTUAL PURPOSES ONLY. THE CONTRACTOR SHALL VERIFY THE EXISTING CONDITIONS AND OBTAIN ALL NECESSARY PERMITS AND APPROVALS PRIOR TO CONSTRUCTION. THE CONTRACTOR SHALL BE RESPONSIBLE FOR OBTAINING ALL NECESSARY PERMITS AND APPROVALS FROM THE LOCAL, STATE, AND FEDERAL AGENCIES. THE CONTRACTOR SHALL BE RESPONSIBLE FOR OBTAINING ALL NECESSARY PERMITS AND APPROVALS FROM THE LOCAL, STATE, AND FEDERAL AGENCIES.
 2. CONSTRUCTION SHALL BE IN ACCORDANCE WITH PROJECT SPECIFICATIONS PROVIDED TO THE CONTRACTOR. THE CONTRACTOR SHALL BE RESPONSIBLE FOR OBTAINING ALL NECESSARY PERMITS AND APPROVALS FROM THE LOCAL, STATE, AND FEDERAL AGENCIES.
 3. THE UTILITY DEPTH SHOWN MAY BE INCREASED AS REQUIRED TO AVOID OBSTACLES OR DELAYS. THE CONTRACTOR SHALL BE RESPONSIBLE FOR OBTAINING ALL NECESSARY PERMITS AND APPROVALS FROM THE LOCAL, STATE, AND FEDERAL AGENCIES.
 4. ALL ASPECTS OF HDD CONSTRUCTION SHALL BE IN ACCORDANCE WITH PROJECT SPECIFICATIONS PROVIDED TO THE CONTRACTOR. THE CONTRACTOR SHALL BE RESPONSIBLE FOR OBTAINING ALL NECESSARY PERMITS AND APPROVALS FROM THE LOCAL, STATE, AND FEDERAL AGENCIES.
 5. THE UTILITY DEPTH SHOWN MAY BE INCREASED AS REQUIRED TO AVOID OBSTACLES OR DELAYS. THE CONTRACTOR SHALL BE RESPONSIBLE FOR OBTAINING ALL NECESSARY PERMITS AND APPROVALS FROM THE LOCAL, STATE, AND FEDERAL AGENCIES.
 6. PERMANENT EMBANKMENT OVER HDD CANNOT BE USED AS A TRAVEL LANE AND A WORK AREA IS REQUIRED.

CH2M HILL

ISSUED FOR CONSTRUCTION
JUNE 29, 2012

Parkway Pipeline LLC
PARKWAY PIPELINE PROJECT
NORCO, LA TO COLLETS, MS
CROSSING SHEET
427643-A-119A
SHEET 0